



TO: Goleta Design Review Board

SUBMITTED BY: Darryl Mimick, Senior Planner

SUBJECT: 7000 Phelps Road (APN 073-440-020) Girsh-Hochman Park Soccer Field Lights Case Nos. 25-0013-DRB/25-0003-SCD

DRB ACTIONS FOR CONSIDERATION:

1. Conduct Final Review for the Girsh-Hochman Park Soccer Field Lights.

PROJECT DESCRIPTION:

This is a request for **Final Review**. The owners of the Girsh-Hochman Soccer Field, the Foundation for Girsh Park, are proposing to replace the existing four temporary mobile soccer field lights with six permanent soccer field LED lights that will not rely on gas fired generators for power.

Lighting of the Girsh-Hochman Soccer Field would be accomplished with the installation of 6 LED lights on wooden poles 50 feet in height. The mounting height of the fixtures would be approximately 38 feet above grade. The light fixtures would be downward facing and would illuminate the field while minimizing/eliminating offsite light spill-over. Power would be brought to the soccer field by directional boring from an electrical source at the Maintenance Building towards the east/west main park to a receiving unit near the storm drain inlet at the Girsh Park Natural Area. This technique would allow for minimal disturbance to the park. Attachment A shows the light levels around the property lines associated with the proposed lights, as well as provides information on the light fixture to be used and the pole elevation.

The existing mobile lights on the soccer field currently operate when there is a request from an organization to rent the field for soccer play and practice. This generally occurs in the fall and winter months. The existing lights operate in conformance with the lighting conditions of the Camino Real Development Plan (95-DP-026) and the permanent LED lights would operate in the same manner. The updating of lighting will not change the timing or frequency of use.

With the installation of the permanent lights, the applicant intends to eliminate the existing light spill-over to adjacent properties and reduce noise and air pollution impacts from the

existing light generators. Additionally, the permanent lights would result in significant cost savings for the property owner. The subject property has a Zoning and General Plan Land Use designation of Open Space Active Recreation (OSAR) and is located in the Inland Zone. The project was filed by Kimberly Schizas of Wynmark, on behalf of The Foundation for Girsh Park, property owner.

DISCUSSION:

On April 8, 2025, the DRB granted Preliminary approval on the design of the Project with no conditions or design changes. Further, on May 8, 2025, the Planning and Environmental Review Director approved the Substantial Conformity Determination (SCD) to Case No. 95-DP-026. Final Design Review is the last step in the design review process and the DRB should focus its review on the final design details.

The design review findings and CEQA determination were adopted by the Design Review Board on April 8, 2025, and DRB's action on Final Design Review is not appealable.

Next steps include: (1) Condition Clearance (2) Issuance of Zoning Clearance; and (3) Building Permits and construction.

ATTACHMENTS:

Attachment A – Lighting Plans

ATTACHMENT 1
PROJECT PLANS

The Lester A. & Viola S. Girsh Park

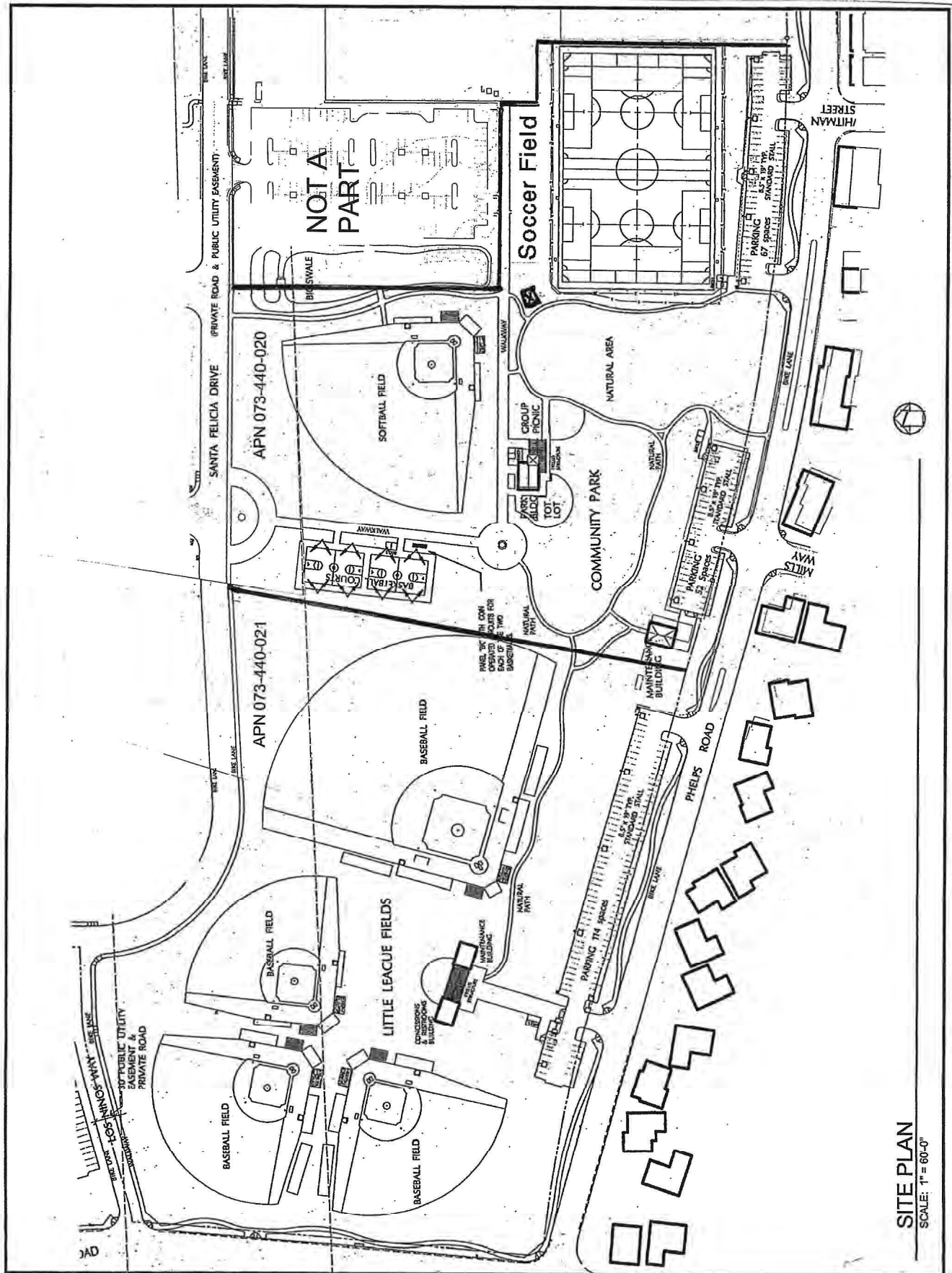

SITE PLAN
SCALE: 1" = 60'-0"

[illegible]

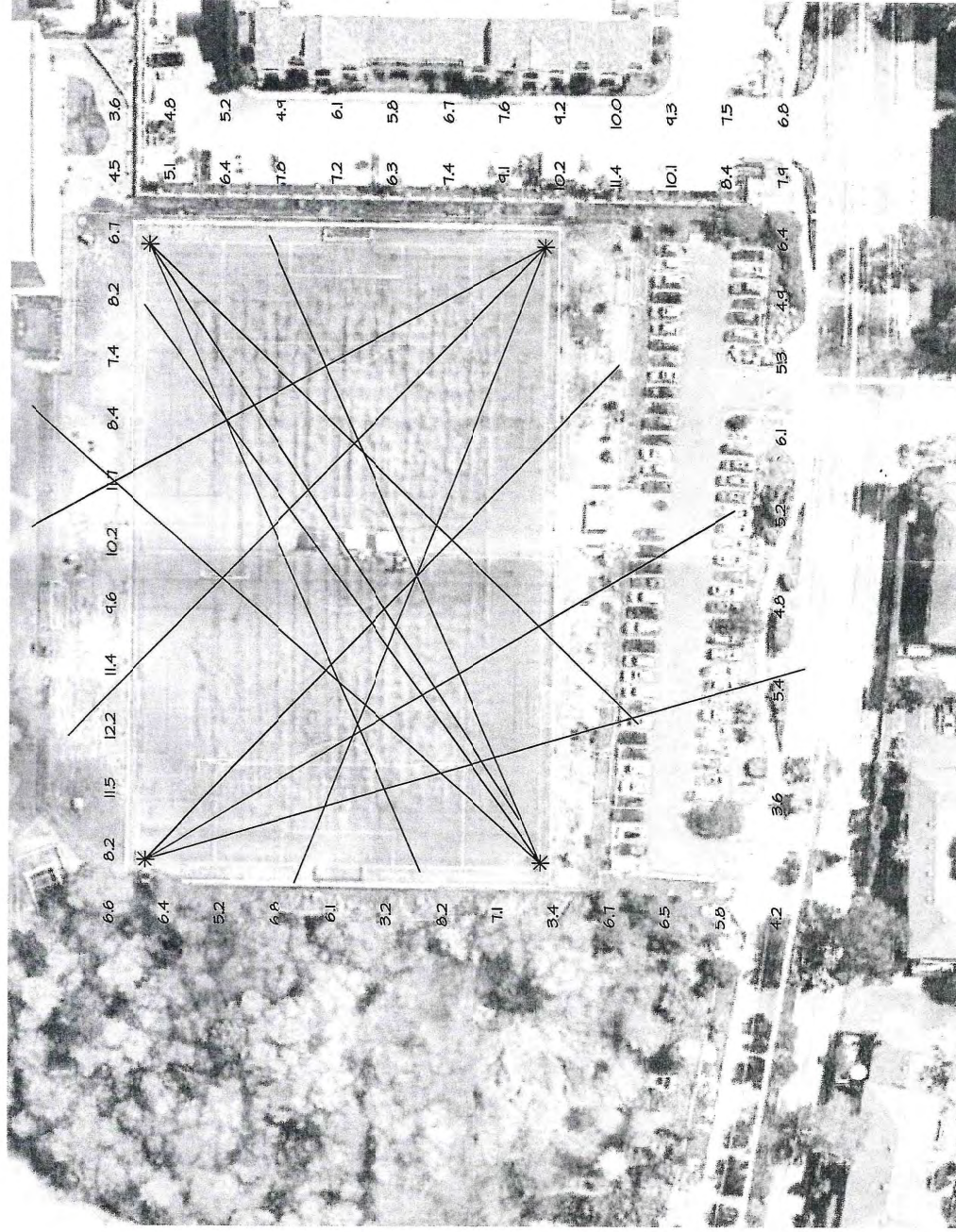

EXISTING TEMPORARY LIGHTING LEVELS - SPILL LIGHT

SCALE: NONE

SCALE: NONE



SCALE:

--	--	--	--

Statistics						
Description	Symbol	Avg	Max	Min	Max/Min	Avg/Min
SOCCER FIELD	+	0.3 fc	5.6 fc	0.0 fc	N/A	N/A

[illegible]