



**TO:** Mayor and Councilmembers

**FROM:** Charles W. Ebeling, Public Works Director

**CONTACT:** Marti Milan, Principal Civil Engineer

**SUBJECT:** Robin Hill Road & South La Patera Lane Street Improvements Notice of Completion

**RECOMMENDATION:**

- A. Adopt Resolution No. 18-\_\_\_\_ entitled "A Resolution of the City Council of the City of Goleta, California, Authorizing the Filing of a Notice of Completion for the Robin Hill Road & South La Patera Lane Street Improvements"; and
- B. Direct the City Clerk to file a Notice of Completion.

**BACKGROUND:**

As a Condition of Approval for the approval of Parcel Map 32,047, the City of Goleta required 6300 Hollister Associates, LP, (Developer) to install frontage improvements along Robin Hill Road and South La Patera Lane (Public Improvements) in accordance with the Subdivision Map Act, prior to issuance of the Certificate of Occupancy for the proposed developments. Parcel Map 32,047 was for a 2-lot subdivision which created the parcel where the Marriott Resident Inn was constructed. The other parcel has a building on it and no site changes were proposed with the parcel map.

Council authorized the Public Works Director to approve final improvement plans "Robin Hill Road & South La Patera Lane Street Improvements" on September 15, 2015. At the same meeting, Council authorized the City Manager to execute the Subdivision Improvement Agreement for the construction of the public street improvements within the public right-of-way on Robin Hill Road and South La Patera Lane. The improvements generally included curb, gutter, sidewalk and landscaping along all frontages of the subdivision. This report summarizes the completion of the construction work release of securities as detailed in the Subdivision Improvement Agreement.

The City of Santa Barbara required the frontage improvements along Hollister Avenue between La Patera Lane and Robin Hill Road. The City of Santa Barbara has accepted these completed improvements.



## DISCUSSION:

Following the approval of the Public Improvement Plans, City staff issued the Developer's contractor, RD Olson, two separate Encroachment Permits (EP): EP16-140 for work on South La Patera Lane, and EP16-141 for work on Robin Hill Road. On August 16, 2016 and August 25, 2016, the EP's were issued. The work consisted of constructing frontage improvements on the southbound side of South La Patera Lane and the northbound side of Robin Hill Road.

RD Olson substantially completed the Public Improvements on August 9, 2018, and over the next few weeks, staff worked with the Developer's engineer, Stantec Inc., to finalize the Record Drawings. Record Drawings of the improvements constructed are attached to this report (Attachment 3). A full-size set of the drawings is available with the City Clerk for review.

Staff recommends that Council: adopt the proposed Resolution 18-\_\_ to accept the Public Improvements (Attachment 1), approve a Notice of Completion for the Public Improvements, and direct the City Clerk to file the Notice of Completion for Public Improvements with the County of Santa Barbara, County Recorder Office (Attachment 2).

## FISCAL IMPACTS:

Acceptance of the Public Improvements will have no fiscal impact on the City. Plan checks and EP costs associated with Public Improvements were paid by Developer.

## ALTERNATIVES:

No other alternatives are proposed as the Developer has complied with and completed the public improvements as required by the City.

**Reviewed By:**

**Legal Review By:**

**Approved By:**



Carmen Nichols  
Deputy City Manager

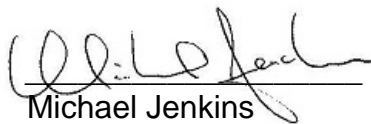

Michael Jenkins  
City Attorney



Michelle Greene  
City Manager



**ATTACHMENTS:**

1. Resolution No. 18-\_\_\_ entitled "A Resolution of the City Council of the City of Goleta, California, Authorizing the Filing of a Notice of Completion for the Robin Hill Road & South La Patera Lane Street Improvements"
2. Notice of Completion.
3. Record Drawings of the Robin Hill Road & South La Patera Lane Street Improvements.







### **Attachment 1**

Resolution No. 18-\_\_\_\_ entitled "A Resolution of the City Council of the City of Goleta, California, Authorizing the Filing of a Notice of Completion for the Robin Hill Road & South La Patera Lane Street Improvements"







**RESOLUTION NO. 18 - \_\_\_\_**

**A RESOLUTION OF THE CITY COUNCIL OF THE CITY OF  
GOLETA, CALIFORNIA, AUTHORIZING THE FILING OF A  
NOTICE OF COMPLETION FOR THE ROBIN HILL ROAD &  
SOUTH LA PATERA LANE STREET IMPROVEMENTS**

**WHEREAS**, on December 15, 2015, the City of Goleta authorized the Subdivision Improvement Agreement between the City of Goleta and 6300 Hollister Associates, L.P. for the Robin Hill Road & South La Patera Lane Street Improvements; and

**WHEREAS**, the City Engineer has evaluated the work and has determined that the work was satisfactorily completed in accordance with the Subdivision Improvement Agreement and City Standards; and

**WHEREAS**, the City Engineer recommends the filing of a Notice of Completion pursuant to Government Code section 20854.

**NOW, THEREFORE, BE IT RESOLVED BY THE CITY COUNCIL OF THE  
CITY OF GOLETA AS FOLLOWS:**

**SECTION 1.**

The work required to be performed by said Contractor has been completed.

**SECTION 2.**

The work is hereby accepted and approved based on the recommendation of the City Engineer.

**SECTION 3.**

Public Works Director and City Clerk are directed to release securities posted for the completion of the project as required by the Subdivision Improvement Agreement.

**SECTION 4.**

The City Clerk is directed to forthwith forward a Notice of Completion to the Recorder of the County of Santa Barbara for recording.



**SECTION 5.**

The City Clerk shall certify to the passage and adoption of this resolution and enter it into the book of original resolutions.

**PASSED, APPROVED, AND ADOPTED** this 18<sup>th</sup> day of October, 2018.

\_\_\_\_\_  
PAULA PEROTTE  
MAYOR

ATTEST:

APPROVED AS TO FORM:

\_\_\_\_\_  
DEBORAH S. LOPEZ  
CITY CLERK

\_\_\_\_\_  
MICHAEL JENKINS  
CITY ATTORNEY



STATE OF CALIFORNIA            )  
COUNTY OF SANTA BARBARA    )  
CITY OF GOLETA                 )       ss.

I, DEBORAH S. LOPEZ, City Clerk of the City of Goleta, California, DO  
HEREBY CERTIFY that the foregoing Resolution No. 18-\_\_\_ was duly adopted by  
the City Council of the City of Goleta at a regular meeting held on the 18<sup>th</sup> day of  
October, 2018, by the following vote of the Council:

AYES:

NOES:

ABSENT:

(SEAL)

\_\_\_\_\_  
DEBORAH S. LOPEZ  
CITY CLERK







## **Attachment 2**

### Notice of Completion







RECORDING REQUESTED BY:  
WHEN RECORDED RETURN TO:

City of Goleta  
130 Cremona Drive, Suite B  
Goleta, CA 93117  
ATTN: CITY CLERK

---

SPACE ABOVE THIS LINE FOR RECORDER'S USE

Exempt from recording fee, per Government Code  
Section 27383

CITY OF GOLETA, CALIFORNIA

By: Deborah S. Lopez  
City Clerk

### NOTICE OF COMPLETION

NOTICE IS HEREBY GIVEN that a Subdivision Improvement Agreement was entered into by the City of Goleta, California and 6300 Hollister Associates, L.P., for the performance of the following work:

#### **ROBIN HILL ROAD & SOUTH LA PATERA LANE STREET IMPROVEMENTS**

Said work was substantially completed on August 9, 2018, by said company; was completed in accordance with City standards and to the satisfaction of the City Engineer of the City of Goleta; and was accepted by the City Council of the City of Goleta, owner, at a regular meeting thereof held on the 8<sup>th</sup> day of October, 2018, by Resolution No. 18-\_\_.

DATED this 8<sup>th</sup> day of October, 2018, at Goleta, California.

I certify under PENALTY OF PERJURY under the laws of the State of California that the foregoing paragraph is true and correct.

---

DEBORAH S. LOPEZ,  
CITY CLERK



STATE OF CALIFORNIA            )  
COUNTY OF SANTA BARBARA    )       ss  
CITY OF GOLETA                 )

I, Deborah S. Lopez, City Clerk of the City of Goleta, California, do hereby certify that the foregoing Notice of Completion is true and correct, and that said Notice of Completion was duly and regularly ordered to be recorded in the Office of the Santa Barbara County Recorder by said City Council.

DATED this 8<sup>th</sup> day of October, 2018, at Goleta, California.

---

DEBORAH S. LOPEZ  
CITY CLERK



## **Attachment 3**

Record Drawings of the Robin Hill Road & South La Patera Lane Street Improvements



# ROBIN HILL ROAD & SOUTH LA PATERA LANE

## STREET IMPROVEMENTS

### GOLETA, CALIFORNIA

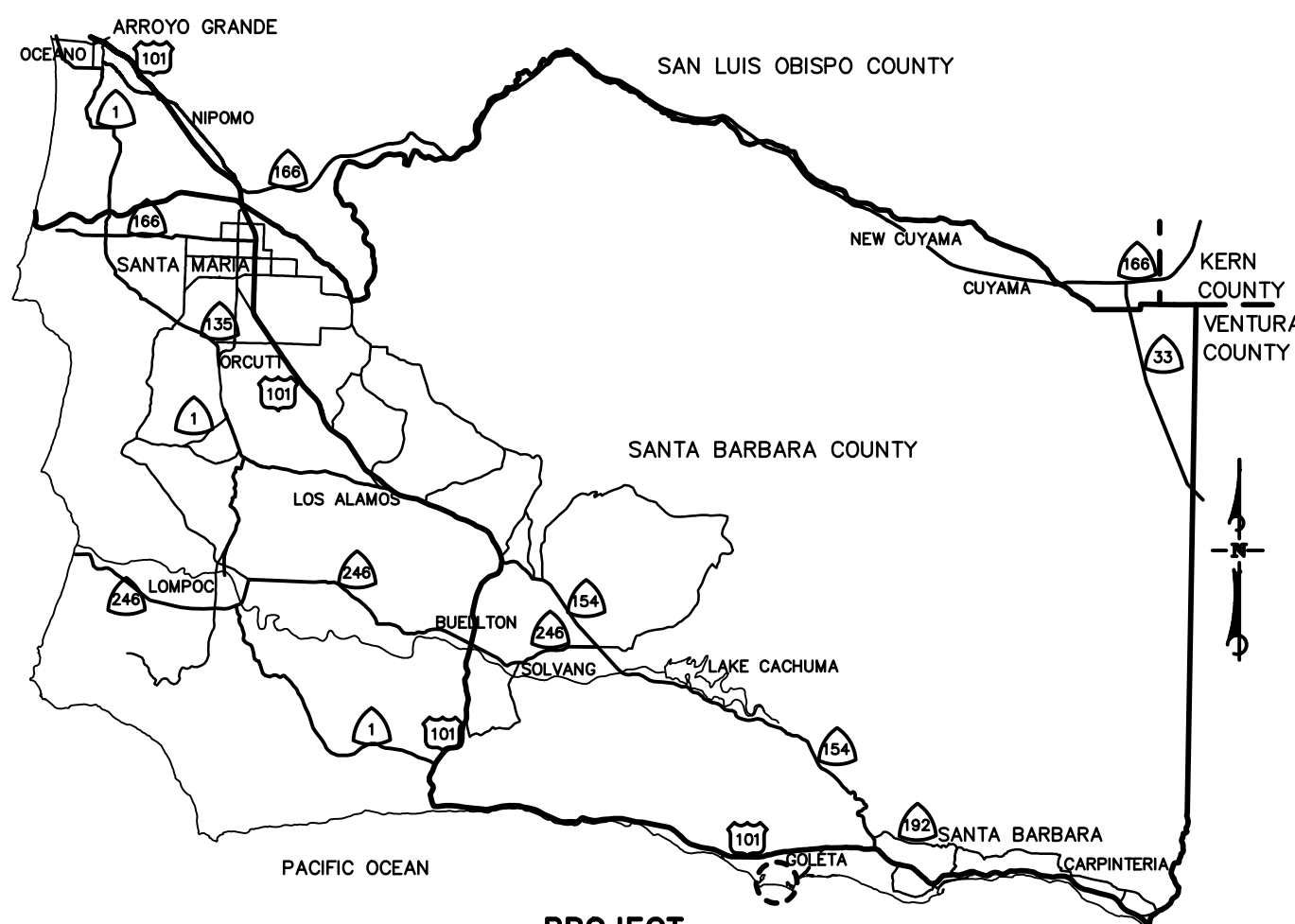

PROJECT LOCATION  
LOCATION MAP  
N.T.S.

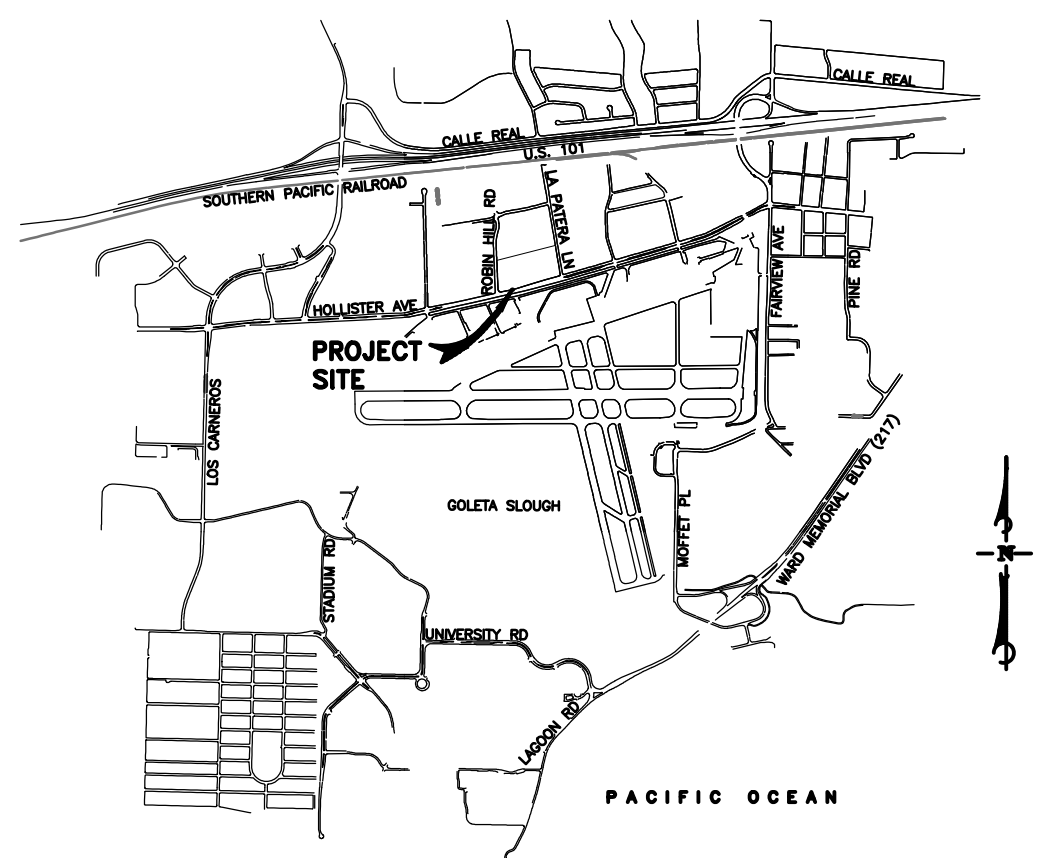

VICINITY MAP  
N.T.S.

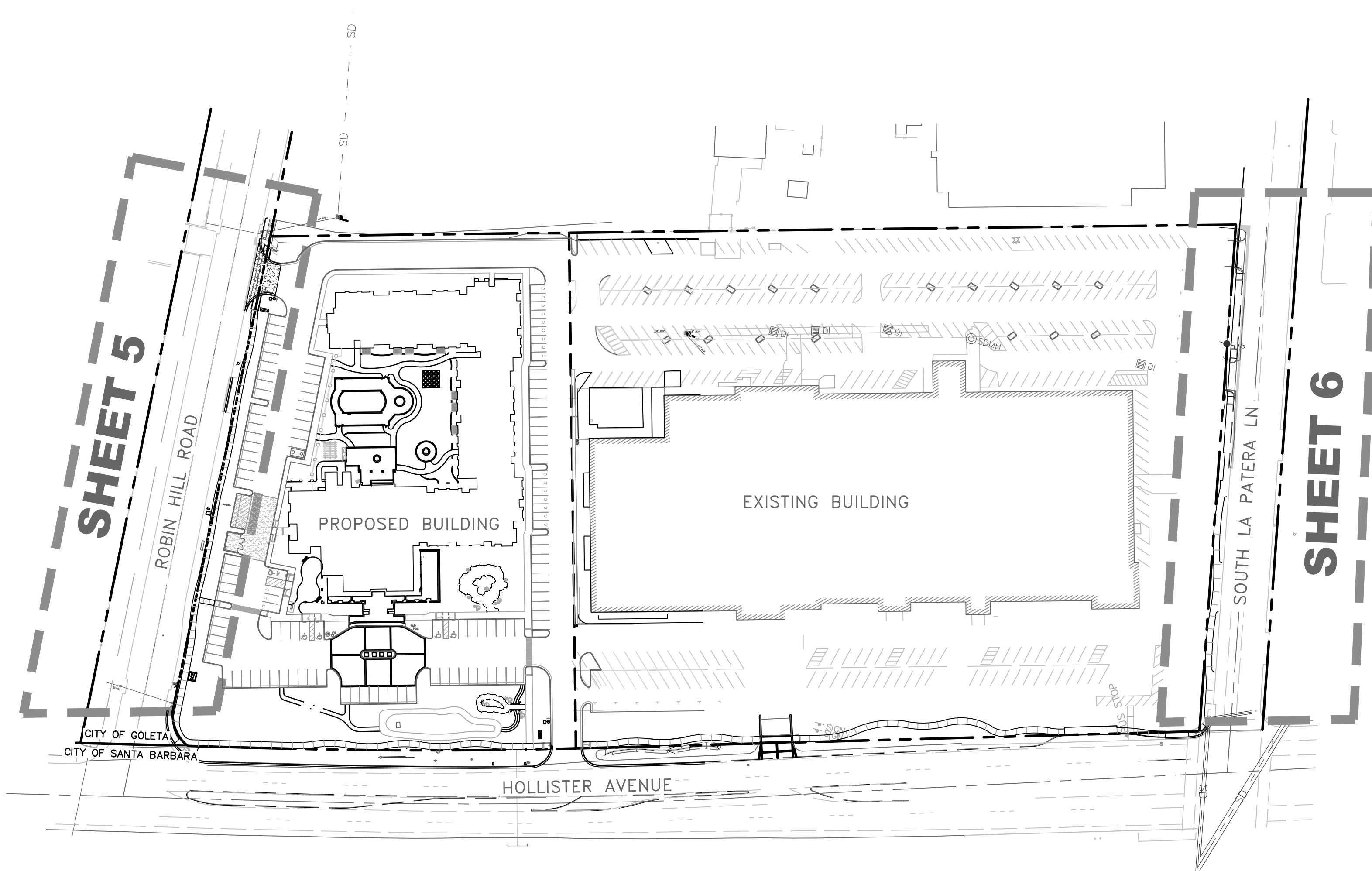

KEY MAP  
SCALE: 1"=80'

#### SHEET INDEX

SHEET NO.	DESCRIPTION
1.	TITLE SHEET
2.	GENERAL NOTES
3.	CONSTRUCTION NOTES & LEGENDS
4.	DETAILS
5.	ROBIN HILL ROAD PLAN & PROFILE
6.	SOUTH LA PATERA LANE PLAN & PROFILE
7.	ROBIN HILL ROAD SIGNING AND STRIPING PLAN

#### SURVEYOR'S NOTES

**1. MAPPING**  
THE TOPOGRAPHIC/PLANIMETRIC INFORMATION SHOWN HEREON WAS COMPILED FROM DATA COLLECTED IN A CONVENTIONAL FIELD SURVEY UNDERTAKEN BY PENFIELD & SMITH IN DECEMBER 2006 AND JANUARY 2007 AT THE REQUEST OF R.D. OLSON DEVELOPMENT.

THE CONVENTIONAL FIELD SURVEY WAS SUPPLEMENTED BY TOPOGRAPHIC/PLANIMETRIC MAPPING COMPILED FROM AERIAL PHOTOGRAPHY DATED MARCH 27, 2000, PREPARED BY GOLDEN STATE AERIAL SURVEYS, INC. AND BY PLANIMETRIC DATA FOR OFFSITE FEATURES PROVIDED BY WATERS LAND SURVEYING.

**2. BOUNDARY AND EASEMENT INFORMATION**  
THIS MAP WAS PREPARED IN CONJUNCTION WITH PRELIMINARY TITLE REPORT ISSUE BY LAND AMERICA LAWYERS TITLE COMPANY AS FILE NO. 1020882, DATED JANUARY 19, 2007 AT 7:30 A.M., AND RECORD MAPPING ON FILE WITH THE COUNTY SURVEYOR OF SAID COUNTY. SAID TITLE REPORT IS PRESUMED TO BE COMPLETE AND ACCURATE. PENFIELD & SMITH DOES NOT WARRANT THE COMPLETENESS OR ACCURACY OF SAID TITLE REPORT. THIS SURVEY TIED TO SEVERAL MONUMENTS OF RECORD IN ORDER TO ORIENT THE COMPILED BOUNDARIES, EASEMENTS, AND PLANIMETRIC DATA TO THE PROJECT DATUM.

**3. BASIS OF BEARINGS AND COORDINATES**  
THE BEARING OF NORTH 03°22'25" WEST FOR THE LINE OF THE EASTERLY RIGHT OF WAY OF ROBIN HILL ROAD, AS SHOWN ON RECORD OF SURVEY FILED WITH THE COUNTY RECORDER IN THE COUNTY OF SANTA BARBARA, CALIFORNIA IN BOOK 114 PAGE 9 WAS USED AS THE BASIS OF BEARINGS FOR THIS MAP.

**4. ELEVATIONS**  
ELEVATIONS SHOWN HEREON ARE EXPRESSED IN U.S. SURVEY FEET AND ARE REFERENCED TO THE NORTH AMERICAN VERTICAL DATUM OF 1988 (NAVD88), DEFINED LOCALLY BY LEVEL TIES TO A 3" BRASS CAP STAMPED "UNITED STATES COAST AND GEODETIC SURVEY A371 1949" IN A CONCRETE FLAG POLE BASE IN FRONT OF THE GOLETA AIRPORT ADMINISTRATION BUILDING. ELEVATION= 15.80 FEET.

#### GENERAL INFORMATION

**PROJECT:**  
RESIDENCE INN BY MARRIOTT  
CORNER OF HOLLISTER AVENUE  
& ROBIN HILL ROAD.  
GOLETA, CA. 93117

**CIVIL ENGINEER:**  
STANTEC  
111 EAST VICTORIA STREET  
SANTA BARBARA, CA 93101  
PHONE: (805) 963-9532  
CONTACT: DAVID RUNDLE

**OWNER:**  
R.D. OLSON DEVELOPMENT  
2955 MAIN STREET, THIRD FLR.  
IRVINE, CA. 92614  
PHONE: (949) 474-2001  
CONTACT: ANTHONY WRZOSEK

**GEOTECHNICAL:**  
HUSHMAND ASSOCIATES, INC.  
250 GODDARD  
IRVINE, CA. 92618  
PHONE: (949) 777-1266  
CONTACT: BEN HUSHMAND

**DEVELOPER:**  
R.D. OLSON DEVELOPMENT  
2955 MAIN STREET, THIRD FLR.  
IRVINE, CA. 92614  
PHONE: (949) 474-2001  
CONTACT: ANTHONY WRZOSEK

#### RECORD DRAWING

THIS DRAWING HAS BEEN REVISED TO REFLECT THE CONTRACTOR'S REPRESENTATION OF THE FACILITIES AS CONSTRUCTED, INCLUDING APPROVED CHANGE ORDERS. SAID REVISIONS MAY ALSO REFLECT THE OBSERVATIONS BY THE OWNER'S REPRESENTATIVES. THE PROJECT ENGINEER DOES NOT GUARANTEE THE ACCURACY OF INFORMATION SHOWN HEREON. ANY INTERESTED PERSON SHOULD MAKE THEIR OWN FIELD INVESTIGATIONS TO CONFIRM THE ACCURATE LOCATIONS OF ANY FACILITY SHOWN ON THIS PLAN.

SIG. *David W. Rundle* DATE: 11/03/17  
R.C.E. No. **48540** EXPIRES: 06/30/18



NO.	DATE	REVISIONS	APPD.



DESIGN SLH CHECKED \_\_\_\_\_  
DAVID W. RUNDLE DATE: \_\_\_\_\_  
PROJECT ENGINEER  
R.C.E. **48,540** (EXP. 6-30-18)

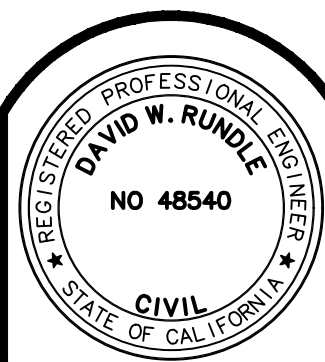

CITY OF GOLETA, CALIFORNIA

REVIEWED BY:

SIGNATURE \_\_\_\_\_ DATE \_\_\_\_\_

ROBIN HILL ROAD AND S. LA PATERA LN  
STREET IMPROVEMENTS  
TITLE SHEET  
CITY OF GOLETA, STATE OF CALIFORNIA

P&S PROJECT NO.  
17636.02  
SHEET  
1 OF 7  
PLAN DATE  
DECEMBER 2, 2015







36-ENG. SAVE DATE: 12/19/2017 1:23:22 PM PLOT BY: Bowman, Katie PLOT DATE: 1/23/2018 2:32:02 PM PLOT SCALE: 1:1

SYMBOL LEGEND

— W —	WATER LINE	→ ———→	FLOWLINE
— E —	ELECTRIC	▲ ▲ ▲	CONCRETE
— S —	SEWER LINE	⊙	MANHOLE
— D —	STORM DRAIN (MINOR)	—○—	POWER POLE
— SD —	STORM DRAIN (MAJOR)	213.70	SPOT ELEVATION
— U —	COMMON UTILITY TRENCH (S.C.E, G.T.E., CATV AND S.C.G.)	⊗	TREE REMOVAL
— G —	GAS LINE	□	DOMESTIC WATER METER
=====	RETAINING, SOUND OR FLOOD WALL	■	RECLAIMED WATER METER
— — — — —	FENCE	● ED	END DRAIN
— T —	EDGE OF A.C. PAVEMENT	○ AV	AIR VALVE
— FSL —	FIRE SPRINKLER LATERAL	☁	APPROXIMATE TREE DRIP LINE (FROM AERIAL DATA)
— RWL —	RECLAIMED WATER LATERAL	(100.00)	EXISTING GRADE
— SL —	SEWER LATERAL	⑩	DESIGNATES CONSTRUCTION NOTE
— WL —	WATER LATERAL	☀	PROPOSED STREET LIGHT
— T —	TELEPHONE		
— OHW —	OVERHEAD WIRE		
=====	CONSTRUCTION CENTERLINE		
— Y —	SLOPE		
— - - - -	PROPOSED RIGHT-OF-WAY		
— - - - -	EXISTING RIGHT-OF-WAY		
— 70 —	INDEX CONTOUR		
— 71 —	INTERMEDIATE CONTOUR		

ABBREVIATIONS

AC	ASPHALTIC CONCRETE	NTS	NOT TO SCALE
ACP	ASBESTOS CEMENT PIPE	OC	ON CURB
AB	AGGREGATE BASE	OHW	OVERHEAD WIRE
AL	ARC LENGTH	PB	PULL BOX
ANG. PT.	ANGLE POINT	PCC	POINT OF COMPOUND CURVATURE
BC	BEGIN CURVE	PI	POINT OF INTERSECTION (CURVE TANGENTS)
BCR	BEGIN CURB RETURN	PL	PROPERTY LINE
BM	BENCHMARK	PRC	POINT OF REVERSE CURVATURE
BVC	BEGIN VERTICAL CURVE	PROP.	PROPOSED
BW	BACK OR WALK	PSE	PRIVATE STREET EASEMENT
CIP	CAST IRON PIPE	PUE	PUBLIC UTILITIES EASEMENT
CJ	CRACK CONTROL JOINT	PVC	POLY-VINYL CHLORIDE
CL	CLASS	R	RADIUS
CCL	CONSTRUCTION CENTERLINE	RCP	REINFORCED CONCRETE PIPE
CLF	CHAIN LINK FENCE	RCAP	REINFORCED CONCRETE ARCH PIPE
CONC.	CONCRETE	RIM	RIM OF MANHOLE
C&G	CURB AND GUTTER	R/W OR ROW	RIGHT-OF-WAY
CMP	CORRUGATED METAL PIPE	RT.	RIGHT
CMU	CONCRETE MASONRY UNIT	S	SEWER
CN	CLEANOUT	SB	SUBBASE
CATV	CABLE TELEVISION	SD	STORM DRAIN
DBL.	DOUBLE	SH	SPRINKLER HEAD
DJ	DROP INLET	SL	STREET LIGHT
DIP	DUCTILE IRON PIPE	STA	STATION
DWY	DRIVEWAY	STD. DET.	STANDARD DETAIL
E	ELECTRICAL	SIDEWALK	SIDEWALK
EC	END CURVE	T	TELEPHONE
ECR	END CURB RETURN	THRUST BLOCK	THRUST BLOCK
EJ	EXPANSION JOINT	TOP OF CONCRETE	TOP OF CONCRETE
EL OR ELEV.	ELEVATION	TOP OF DIKE	TOP OF DIKE
EOP	EDGE OF PAVEMENT	TOP OF FOOTING	TOP OF FOOTING
EVC	END VERTICAL CURVE	TOP OF GRATE	TOP OF GRATE
EX. OR EXIST.	EXISTING	TI	TRAFFIC INDEX
FF	FINISH FLOOR	TL	TRAFFIC LIGHT
FG	FINISH GRADE	TP	TOP OF PAVEMENT
FH	FIRE HYDRANT	TYP	TYPICAL
FL	FLOWLINE	TW	TOP OF WALL
FLG	FLANGE	VCP	VITRIFIED CLAY PIPE
FS	FINISH SURFACE	VL.	VAULT
G	GAS	VLV.	VALVE
GM	GAS METER	VPI	VERTICAL POINT OF INTERSECTION (CURVE TANGENTS)
GB	GRADE BREAK	W	WATER
GSP	GALVANIZED STEEL PIPE	WM	WATER METER
GUT	GUTTER	WV	WATER VALVE
HP	HIGH POINT	⊙	DELTA (CURVE CENTRAL ANGLE)
INT.	INTERSECTION	±	APPROXIMATELY
INV	INVERT OF PIPE/FLOWLINE	%	PERCENT
IRC	IRRIGATION CONTROL VALVE	<	LESS THAN
IRR.	IRRIGATION	>	GREATER THAN
L	CURVE LENGTH	°, ", "	DEGREES, MINUTES, SECONDS
LDSCAPE	LANDSCAPE		
LGTP.	LIGHT POLE		
LF	LINEAL FEET		
LP	LOW POINT		
LT.	LEFT		
MH	MANHOLE		
MJ	MECHANICAL JOINT		
N.I.C.	NOT INCLUDED IN CONTRACT		

CONSTRUCTION NOTES

- 1 CONSTRUCT MINIMUM 4" ASPHALT CONCRETE PAVEMENT, CALTRANS ½" HMA TYPE A, OVER MINIMUM 6" AGGREGATE BASE CLASS II, OR MATCH EXISTING, WHICHEVER IS GREATER. FINAL STRUCTURAL SECTION TO BE DETERMINED BY CITY OF GOLETA.
- 2 CONSTRUCT TYPE A 6" CURB AND 18" GUTTER PER SANTA BARBARA COUNTY DEPARTMENT OF PUBLIC WORKS STANDARD DETAIL 4-030.
- 3 CONSTRUCT PLAN A COMMERCIAL DRIVEWAY PER SANTA BARBARA COUNTY DEPARTMENT OF PUBLIC WORKS STANDARD DETAIL 4-040. WIDTH PER PLAN.
- 4 CONSTRUCT SPANDREL AND CROSS GUTTER PER SANTA BARBARA COUNTY DEPARTMENT OF PUBLIC WORKS STANDARD DETAIL 4-020.
- 5 CONSTRUCT 4" THICK SIDEWALK PER SANTA BARBARA COUNTY DEPARTMENT OF PUBLIC WORKS STANDARD DETAIL 5-040.
- 6 CONSTRUCT ADA COMPLIANT ACCESS RAMP PER 2010 CALTRANS REVISED STANDARD PLAN A88A, CASE "F".
- 7 INSTALL STREET LIGHT PER DETAIL "A", SHEET 4.
- 8 LANDSCAPE PER LANDSCAPE ARCHITECT'S PLANS.
- 9 CONSTRUCT TYPE A 6" CURB ONLY PER SANTA BARBARA COUNTY DEPARTMENT OF PUBLIC WORKS STANDARD DETAIL 4-030.
- 10 CONSTRUCT PLAN B COMMERCIAL DRIVEWAY PER SANTA BARBARA COUNTY DEPARTMENT OF PUBLIC WORKS STANDARD DETAIL 4-040. WIDTH PER PLAN.
- 11 CONSTRUCT ADA COMPLIANT ACCESS RAMP AND RETENTION CURB PER SSPWC 111-4 CASE D TYPE 2.

REMOVAL/RELOCATION NOTES

- 1 SAWCUT EXISTING ASPHALT A MINIMUM OF 1' BEYOND EXISTING GUTTER TO PROVIDE A CLEAN, SMOOTH JOIN LINE.
- 2 REMOVE EXISTING ASPHALT CONCRETE PAVEMENT TO FULL DEPTH, AND DISPOSE OF OFF-SITE.
- 3 REMOVE EXISTING CONCRETE CURB AND GUTTER AND DISPOSE OF OFF-SITE.
- 4 PROTECT EXISTING UTILITY IN PLACE.
- 5 PROTECT EXISTING UTILITY VAULT/METER IN PLACE. ADJUST TO GRADE AS NEEDED.
- 6 PROTECT EXISTING CURB OPENING CATCH BASIN.
- 7 PROTECT EXISTING UTILITY MANHOLE IN PLACE.
- 8 REMOVE EXISTING DRIVEWAY AND DISPOSE OFF-SITE.
- 9 REMOVE EXISTING CONCRETE CURB AND DISPOSE OF OFF-SITE.
- 10 RELOCATE PER UTILITY PROVIDER PLAN.
- 11 REMOVE EXISTING ABANDONED SEWER MANHOLE AND DISPOSE OF OFF-SITE.

RECORD DRAWING

THIS DRAWING HAS BEEN REVISED TO REFLECT THE CONTRACTOR'S REPRESENTATION OF THE FACILITIES AS CONSTRUCTED, INCLUDING APPROVED CHANGE ORDERS. SAID REVISIONS MAY ALSO REFLECT THE OBSERVATIONS BY THE OWNER'S REPRESENTATIVES. THE PROJECT ENGINEER DOES NOT GUARANTEE THE ACCURACY OF INFORMATION SHOWN HEREON. ANY INTERESTED PERSON SHOULD MAKE THEIR OWN FIELD INVESTIGATIONS TO CONFIRM THE ACCURATE LOCATIONS OF ANY FACILITY SHOWN ON THIS PLAN.

SIG. David W. Rundle DATE: 11/03/17  
R.C.E. No. 48540 EXPIRES: 06/30/18

NO.	DATE	REVISIONS	APPD.



111 East Victoria Street, Santa Barbara, CA 93101  
Phone: (805) 963-9532 Fax: (805) 966-9801

DESIGN SLH CHECKED \_\_\_\_\_  
DAVID W. RUNDLE DATE: \_\_\_\_\_  
PROJECT ENGINEER  
R.C.E. **48,540** (EXP. **6-30-18**)



CITY OF GOLETA, CALIFORNIA  
REVIEWED BY: \_\_\_\_\_  
SIGNATURE \_\_\_\_\_ DATE \_\_\_\_\_

ROBIN HILL ROAD AND S. LA PATERA LN  
STREET IMPROVEMENTS  
CONSTRUCTION NOTES & LEGENDS  
CITY OF GOLETA, STATE OF CALIFORNIA

P&S PROJECT NO.	17636.02
SHEET	3 OF 7
PLAN DATE	DECEMBER 2, 2015

DRAWING: x:\2064\active\2064017636\17636\ocad\rfalte-streets\city of goleta\17636-c01-04.dwg\_city\_of\_goleta.dwg



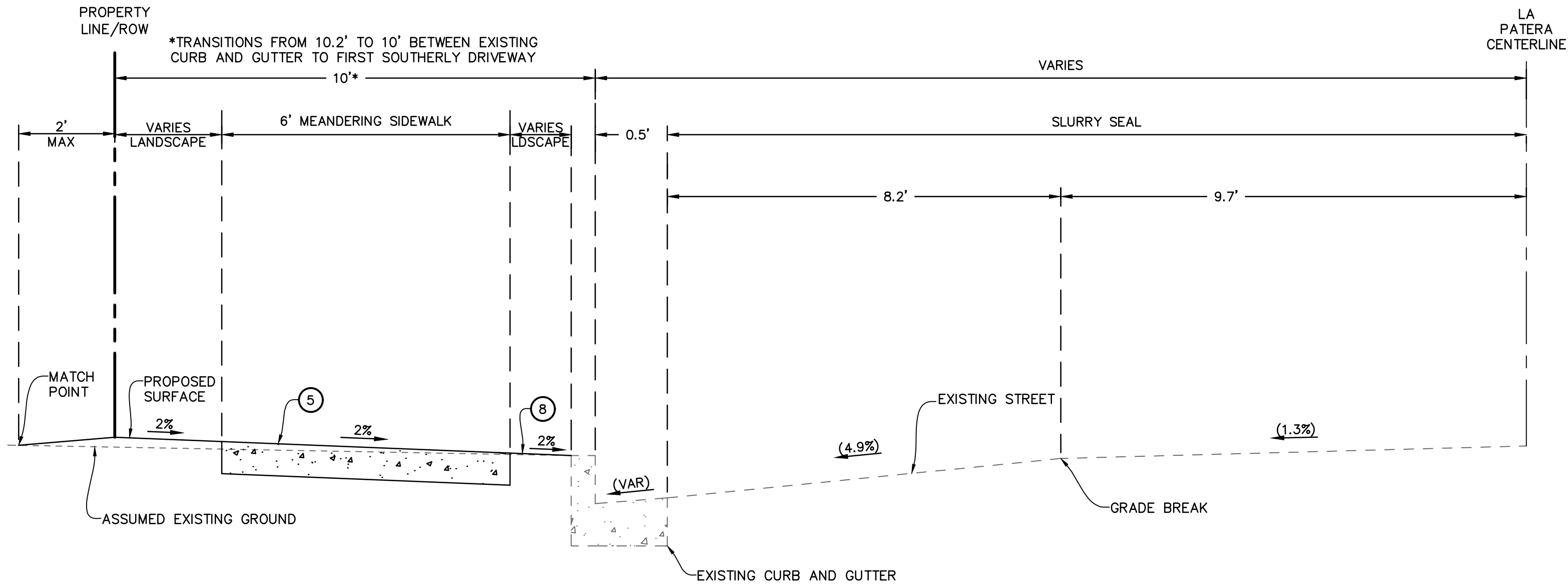

### SOUTH LA PATERA LANE TYPICAL SECTION- STA 10+81.67 - 12+89.94

SCALE: HORIZ. 1"=2'  
VERT. 1"=1'

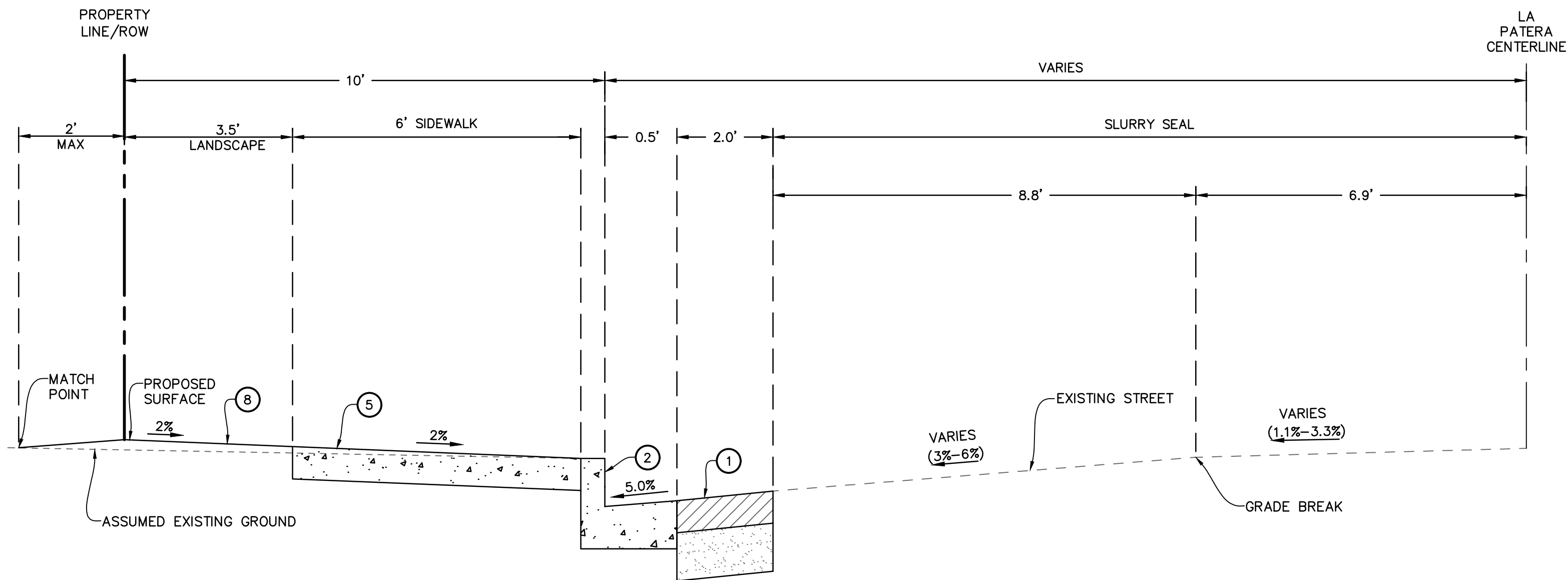

### SOUTH LA PATERA LANE TYPICAL SECTION- STA 12+89.94 - 14+69.31

SCALE: HORIZ. 1"=2'  
VERT. 1"=1'

### CONSTRUCTION NOTES

1. CONSTRUCT MINIMUM 4" ASPHALT CONCRETE PAVEMENT, CALTRANS 2" HMA TYPE A, OVER MINIMUM 6" AGGREGATE BASE CLASS II, OR MATCH EXISTING, WHICHEVER IS GREATER. FINAL STRUCTURAL SECTION TO BE DETERMINED BY CITY OF GOLETA.
2. CONSTRUCT TYPE A 6" CURB AND 18" GUTTER PER SANTA BARBARA COUNTY DEPARTMENT OF PUBLIC WORKS STANDARD DETAIL 4-030.
5. CONSTRUCT 4" THICK SIDEWALK PER SANTA BARBARA COUNTY DEPARTMENT OF PUBLIC WORKS STANDARD DETAIL 5-040.
8. LANDSCAPE PER LANDSCAPE ARCHITECT'S PLANS.

### RECORD DRAWING

THIS DRAWING HAS BEEN REVISED TO REFLECT THE CONTRACTOR'S REPRESENTATION OF THE FACILITIES AS CONSTRUCTED, INCLUDING APPROVED CHANGE ORDERS. SAID REVISIONS MAY ALSO REFLECT THE OBSERVATIONS BY THE OWNER'S REPRESENTATIVES. THE PROJECT ENGINEER DOES NOT GUARANTEE THE ACCURACY OF INFORMATION SHOWN HEREON. ANY INTERESTED PERSON SHOULD MAKE THEIR OWN FIELD INVESTIGATIONS TO CONFIRM THE ACCURATE LOCATIONS OF ANY FACILITY SHOWN ON THIS PLAN.

SIG. David W. Rundel DATE: 11/03/17  
R.C.E. No. 48540 EXPIRES: 06/30/18

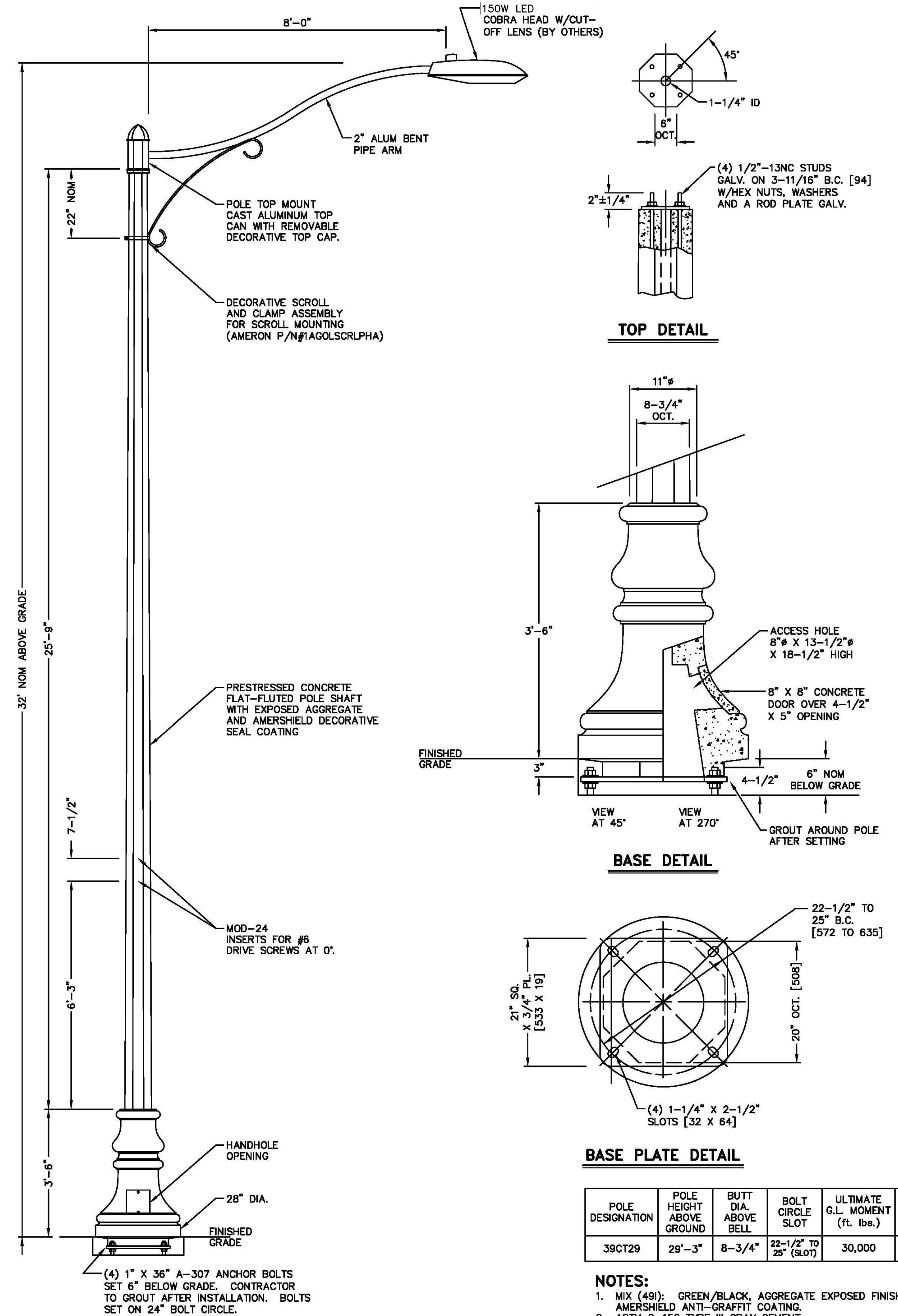

POLE DESIGNATION	POLE HEIGHT ABOVE GROUND	BUTT DIA. ABOVE BELL	BOLT CIRCLE SLOT	ULTIMATE G.L. MOMENT (ft. lbs.)	WEIGHT (lbs.)
39CT29	29'-3"	8'-3/4"	22'-1/2" TO 25" (SLOT)	30,000	1,600

- NOTES:**
1. MIX (49): GREEN/BLACK, AGGREGATE EXPOSED FINISH, WITH AMERSHIELD ANTI-GRAFFITI COATING.
  2. ASTM C-150 TYPE III GRAY CEMENT.
  3. f'c @ 28 DAYS = 6,000 PSI, USING SPUN CYLINDER TEST.
  4. f'c @ 28 DAYS = 5,000 PSI, USING ASTM C-31 CYLINDER TEST.
  5. POLES MANUFACTURED PER ASTM C1089-97 SPECIFICATIONS.
  6. ASTM A-36 STEEL BASE PLATE FULLY PRE-STRESSED WITH (8) ASTM A-416 PRESTRESSING TENDONS (7-STRAND CABELS).
  7. LMA & SCROLL TO BE COATED BLACK GREEN (RAL6012) "PH".
  8. AMERON CUSTOMER SERVICE NOTE: POLE, LMA, & TOP CAP ARE INCLUDED IN THE ORDER ENTRY NUMBER. ALSO REQUIRED IS THE SCROLL ASSEMBLY PART NUMBER (P/N# 1AGOLSCRLPHA) AS A SEPERATE LINE ITEM (BUT A PART OF THE 040-00840).

### CITY OF GOLETA LIGHT STANDARD DETAIL

N.T.S.

A  
5



111 East Victoria Street, Santa Barbara, CA 93101  
Phone: (805) 963-9532 Fax: (805) 966-9801

DESIGN SLH \_\_\_\_\_ CHECKED \_\_\_\_\_  
DAVID W. RUNDLE DATE: \_\_\_\_\_  
PROJECT ENGINEER  
R.C.E. 48,540 (EXP. 6-30-18)

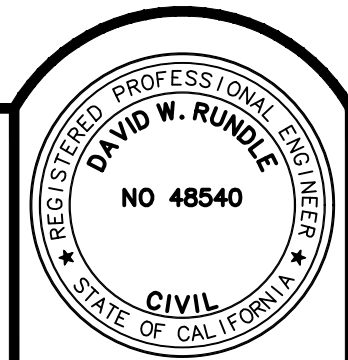

CITY OF GOLETA, CALIFORNIA

REVIEWED BY:

SIGNATURE \_\_\_\_\_ DATE \_\_\_\_\_

ROBIN HILL ROAD AND S. LA PATERA LN  
STREET IMPROVEMENTS  
DETAILS

CITY OF GOLETA, STATE OF CALIFORNIA

P&S PROJECT NO.  
17636.02  
SHEET  
4 OF 7  
PLAN DATE  
DECEMBER 2, 2015



# RECORD DRAWING

THIS DRAWING HAS BEEN REVISED TO REFLECT THE CONTRACTOR'S REPRESENTATION OF THE FACILITIES AS CONSTRUCTED, INCLUDING APPROVED CHANGE ORDERS. SAID REVISIONS MAY ALSO REFLECT THE OBSERVATIONS BY THE OWNER'S REPRESENTATIVES. THE PROJECT ENGINEER DOES NOT GUARANTEE THE ACCURACY OF INFORMATION SHOWN HEREON. ANY INTERESTED PERSON SHOULD MAKE THEIR OWN FIELD INVESTIGATIONS TO CONFIRM THE ACCURATE LOCATIONS OF ANY FACILITY SHOWN ON THIS PLAN.

SIG. *David W. Rundle* DATE: 11/03/17  
R.C.E. No. 48540 EXPIRES: 06/30/18

SCALE: HORIZ. 1"=20'  
VERT. 1"=4'

## CONSTRUCTION NOTES

- CONSTRUCT MINIMUM 4" ASPHALT CONCRETE PAVEMENT, CALTRANS 1/2" HMA TYPE A, OVER MINIMUM 6" AGGREGATE BASE CLASS II, OR MATCH EXISTING, WHICHEVER IS GREATER. FINAL STRUCTURAL SECTION TO BE DETERMINED BY CITY OF GOLETA.
- CONSTRUCT TYPE A 6" CURB AND 18" GUTTER PER SANTA BARBARA COUNTY DEPARTMENT OF PUBLIC WORKS STANDARD DETAIL 4-030.
- CONSTRUCT PLAN A COMMERCIAL DRIVEWAY PER SANTA BARBARA COUNTY DEPARTMENT OF PUBLIC WORKS STANDARD DETAIL 4-040. WIDTH PER PLAN.
- CONSTRUCT SPANDREL AND CROSS GUTTER PER SANTA BARBARA COUNTY DEPARTMENT OF PUBLIC WORKS STANDARD DETAIL 4-020.
- CONSTRUCT 4" THICK SIDEWALK PER SANTA BARBARA COUNTY DEPARTMENT OF PUBLIC WORKS STANDARD DETAILS 5-040 AND 5-045.
- CONSTRUCT ADA COMPLIANT ACCESS RAMP PER 2010 CALTRANS REVISED STANDARD PLAN AB8A, CASE "F".
- INSTALL STREET LIGHT PER DETAIL "A", SHEET 4.
- LANDSCAPE PER LANDSCAPE ARCHITECT'S PLANS.
- CONSTRUCT TYPE A 6" CURB ONLY PER SANTA BARBARA COUNTY DEPARTMENT OF PUBLIC WORKS STANDARD DETAIL 4-030.

## REMOVAL/RELOCATION NOTES

- SAWCUT EXISTING ASPHALT A MINIMUM OF 2' BEYOND EXISTING GUTTER TO PROVIDE A CLEAN, SMOOTH JOIN LINE.
- REMOVE EXISTING ASPHALT CONCRETE PAVEMENT TO FULL DEPTH, AND DISPOSE OF OFF-SITE.
- REMOVE EXISTING CONCRETE CURB AND GUTTER AND DISPOSE OF OFF-SITE.
- PROTECT EXISTING UTILITY IN PLACE.
- PROTECT EXISTING UTILITY VAULT/VALVE/METER IN PLACE. ADJUST TO GRADE AS NEEDED.
- PROTECT EXISTING CURB OPENING CATCH BASIN.
- PROTECT EXISTING UTILITY MANHOLE IN PLACE.
- REMOVE EXISTING DRIVEWAY AND DISPOSE OFF-SITE.
- REMOVE EXISTING CONCRETE CURB AND DISPOSE OF OFF-SITE.
- RELOCATE PER UTILITY PROVIDER PLAN.
- REMOVE EXISTING ABANDONED SEWER MANHOLE AND DISPOSE OF OFF-SITE.
- REMOVE EXISTING TREE.

## GENERAL NOTES

- CONTRACTOR TO REPAIR OR REPLACE BROKEN CURB, GUTTER, AND SIDEWALK ALONG THE PROPERTY FRONTAGE ON ROBIN HILL ROAD PER SANTA BARBARA COUNTY DEPARTMENT OF PUBLIC WORKS STANDARD DETAIL 4-030. LOCATIONS TO BE FIELD DETERMINED.
- CITY ARBORIST WILL BE CONTACTED PRIOR TO ANY TREE AND ROOT PRUNING. SEE LANDSCAPE PLANS FOR ALL ROOT BARRIER LOCATIONS.

## SIDEWALK LINE TABLE

LINE	LENGTH	DIRECTION
L3	39.57'	N32°41'W

\*GEOMETRY TAKEN FROM SIDEWALK CENTERLINE

## SIDEWALK CURVE TABLE

CURVE	DELTA	RADIUS	LENGTH
C3	47°00'33"	25.47'	20.90'
C4	61°2'32"	347.08'	37.61'
C5	14°04'51"	233.55'	57.40'
C6	5°21'58"	606.13'	56.77'
C7	8°48'09"	255.96'	39.32'
C8	5°59'21"	543.50'	56.81'
C9	3°29'15"	632.47'	38.50'
C10	8°06'47"	128.16'	18.15'
C11	14°08'00"	197.00'	48.59'
C12	6°28'00"	33.03'	3.73'

\*GEOMETRY TAKEN FROM SIDEWALK CENTERLINE

## CURB TANGENT TABLE

LINE	BEARING	DISTANCE
L1	N 32°53' W	33.94'
L2	N88°37'48"E	3.13'

## CURB CURVE TABLE

CURVE	DELTA	RADIUS	LENGTH
C1	93°26'39"	20.00'	32.62'
C2	100°24'34"	20.00'	35.04'

SCALE: 1"=20'

NO.	DATE	REVISIONS	APPD.
1		Moved Water Meters, Backflows and FH to Behind Sidewalk due to conc. encased ducts	
2		Deleted curb on east side of sidewalk.	

**Stantec**  
111 East Victoria Street, Santa Barbara, CA 93101  
Phone: (805) 963-9532 Fax: (805) 966-9801

DESIGN SLH CHECKED \_\_\_\_\_  
DAVID W. RUNDLE DATE: \_\_\_\_\_  
PROJECT ENGINEER  
R.C.E. 48,540 (EXP. 6-30-18)

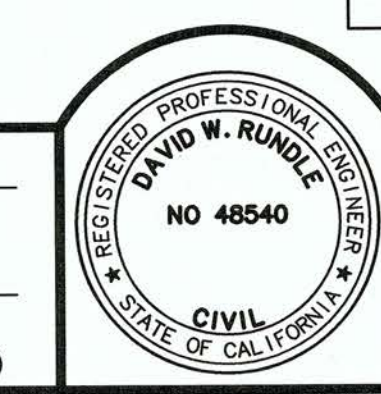

CITY OF GOLETA, CALIFORNIA  
REVIEWED BY: \_\_\_\_\_  
SIGNATURE \_\_\_\_\_ DATE \_\_\_\_\_

STREET IMPROVEMENTS  
ROBIN HILL ROAD  
STA. 10+50.92 - STA. 15+79.97  
CITY OF GOLETA, STATE OF CALIFORNIA

P&S PROJECT NO. 17636.02  
SHEET 5 OF 7  
PLAN DATE DECEMBER 2, 2015



# RECORD DRAWING

THIS DRAWING HAS BEEN REVISED TO REFLECT THE CONTRACTOR'S REPRESENTATION OF THE FACILITIES AS CONSTRUCTED, INCLUDING APPROVED CHANGE ORDERS. SAID REVISIONS MAY ALSO REFLECT THE OBSERVATIONS BY THE OWNER'S REPRESENTATIVES. THE PROJECT ENGINEER DOES NOT GUARANTEE THE ACCURACY OF INFORMATION SHOWN HEREON. ANY INTERESTED PERSON SHOULD MAKE THEIR OWN FIELD INVESTIGATIONS TO CONFIRM THE ACCURATE LOCATIONS OF ANY FACILITY SHOWN ON THIS PLAN.

SIG. David W. Rundle DATE: 11/03/17  
R.C.E. No. 48540 EXPIRES: 06/30/18

STA 10+50.92  
SOUTHERN SLURRY SEAL  
LIMIT ON ROBIN HILL ROAD

SCALE: HORIZ. 1"=20'  
VERT. 1"=4'

## CONSTRUCTION NOTES

- CONSTRUCT MINIMUM 4" ASPHALT CONCRETE PAVEMENT, CALTRANS 1/2" HMA TYPE A, OVER MINIMUM 6" AGGREGATE BASE CLASS II, OR MATCH EXISTING, WHICHEVER IS GREATER. FINAL STRUCTURAL SECTION TO BE DETERMINED BY CITY OF GOLETA.
- CONSTRUCT TYPE A 6" CURB AND 18" GUTTER PER SANTA BARBARA COUNTY DEPARTMENT OF PUBLIC WORKS STANDARD DETAIL 4-030.
- CONSTRUCT 4" THICK SIDEWALK PER SANTA BARBARA COUNTY DEPARTMENT OF PUBLIC WORKS STANDARD DETAILS 5-040 AND 5-045.
- LANDSCAPE PER LANDSCAPE ARCHITECT'S PLANS.
- CONSTRUCT TYPE A 6" CURB ONLY PER SANTA BARBARA COUNTY DEPARTMENT OF PUBLIC WORKS STANDARD DETAIL 4-030.
- CONSTRUCT PLAN B COMMERCIAL DRIVEWAY PER SANTA BARBARA COUNTY DEPARTMENT OF PUBLIC WORKS STANDARD DETAIL 4-040. WIDTH PER PLAN.
- CONSTRUCT ADA COMPLIANT ACCESS RAMP AND RETENTION CURB PER SSPWC 111-4 CASE D TYPE 2.

## REMOVAL/RELOCATION NOTES

- SAWCUT EXISTING ASPHALT A MINIMUM OF 2' BEYOND EXISTING GUTTER TO PROVIDE A CLEAN, SMOOTH JOIN LINE.
- REMOVE EXISTING ASPHALT CONCRETE PAVEMENT TO FULL DEPTH, AND DISPOSE OF OFF-SITE.
- PROTECT EXISTING UTILITY IN PLACE.
- PROTECT EXISTING UTILITY VAULT/VALVE/METER IN PLACE. ADJUST TO GRADE AS NEEDED.
- PROTECT EXISTING CURB OPENING CATCH BASIN.
- PROTECT EXISTING UTILITY MANHOLE IN PLACE.

## GENERAL NOTES

- CITY ARBORIST WILL BE CONTACTED PRIOR TO ANY TREE AND ROOT PRUNING. SEE LANDSCAPE PLANS FOR ALL ROOT BARRIER LOCATIONS.

## LINE TABLE

LINE	LENGTH	DIRECTION
L4	70.12'	N10°51'30"W
L5	1.66'	S75°13'07"W
L6	2.26'	N75°22'32"E
L7	81.29'	N10°51'30"W
L8	5.25'	S79°07'02"W
L9	2.54'	N79°07'02"E
L10	1.65'	N10°51'30"W
L11	2.55'	S79°07'02"W

## CURVE TABLE

CURVE	DELTA	RADIUS	LENGTH
C16	93°58'23"	5.00'	8.20'
C17	85°44'07"	5.00'	7.48'
C18	90°00'00"	5.00'	7.85'
C19	90°00'00"	5.00'	7.85'
C20	89°58'32"	5.00'	7.85'

## SIDEWALK CURVE TABLE

CURVE	DELTA	RADIUS	LENGTH
C13	14°58'23"	276.31'	72.21'
C14	12°53'49"	200.22'	45.07'
C15	14°54'55"	276.68'	72.03'

\*GEOMETRY TAKEN FROM  
SIDEWALK CENTERLINE

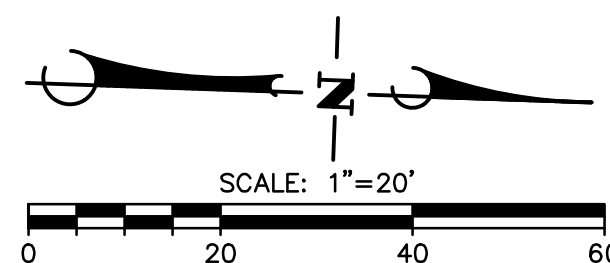

36-PP1 SAVE DATE: 1/23/2018 2:28:43 PM PLOT BY: Bowman, Katie PLOT DATE: 1/23/2018 2:29:29 PM PLOT SCALE: 1:20.28

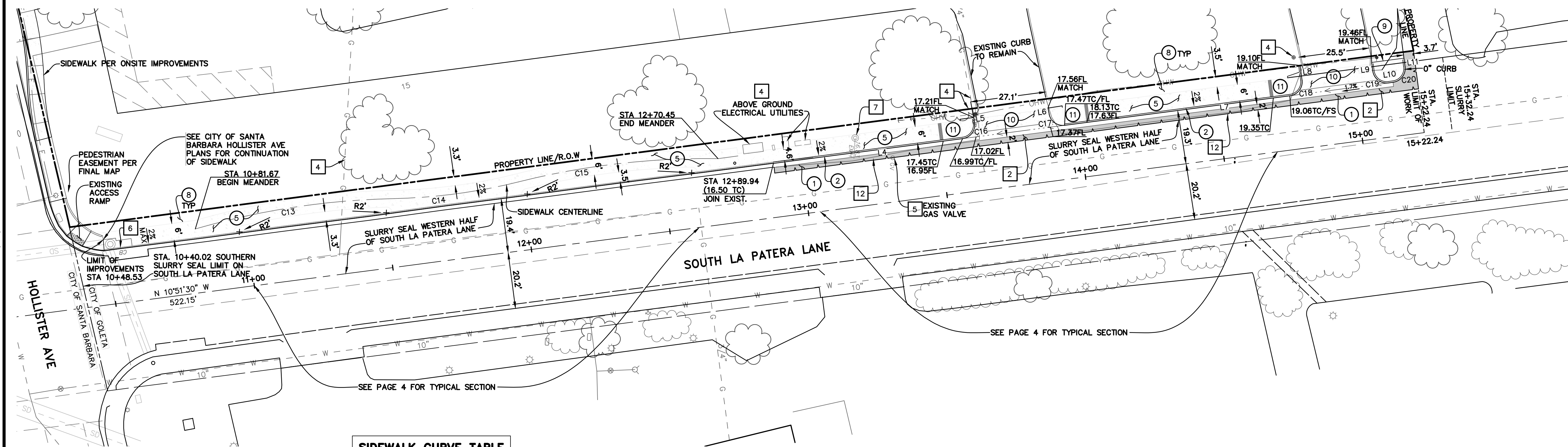

## RECORD DRAWING

THIS DRAWING HAS BEEN REVISED TO REFLECT THE CONTRACTOR'S REPRESENTATION OF THE FACILITIES AS CONSTRUCTED, INCLUDING APPROVED CHANGE ORDERS. SAID REVISIONS MAY ALSO REFLECT THE OBSERVATIONS BY THE OWNER'S REPRESENTATIVES. THE PROJECT ENGINEER DOES NOT GUARANTEE THE ACCURACY OF INFORMATION SHOWN HEREON. ANY INTERESTED PERSON SHOULD MAKE THEIR OWN FIELD INVESTIGATIONS TO CONFIRM THE ACCURATE LOCATIONS OF ANY FACILITY SHOWN ON THIS PLAN.

SIG. David W. Rundle DATE: 11/03/17  
R.C.E. No. 48540 EXPIRES: 06/30/18



DESIGN SLH CHECKED \_\_\_\_\_  
DAVID W. RUNDLE DATE: \_\_\_\_\_  
PROJECT ENGINEER  
R.C.E. 48,540 (EXP. 6-30-18)

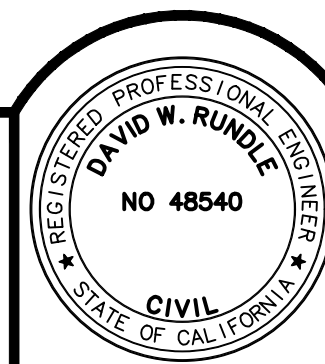

CITY OF GOLETA, CALIFORNIA

REVIEWED BY:

SIGNATURE \_\_\_\_\_ DATE \_\_\_\_\_

STREET IMPROVEMENTS  
SOUTH LA PATERA LANE  
STA. 10+40.02 - STA. 15+22.24  
CITY OF GOLETA, STATE OF CALIFORNIA

P&S PROJECT NO.  
17636.02  
SHEET  
6 OF 7  
PLAN DATE  
DECEMBER 2, 2015



36-ENG SAVE DATE: 12/19/2017 1:23:59 PM PLOT BY: Bowman, Katie PLOT DATE: 1/23/2018 2:33:15 PM PLOT SCALE: 1:1

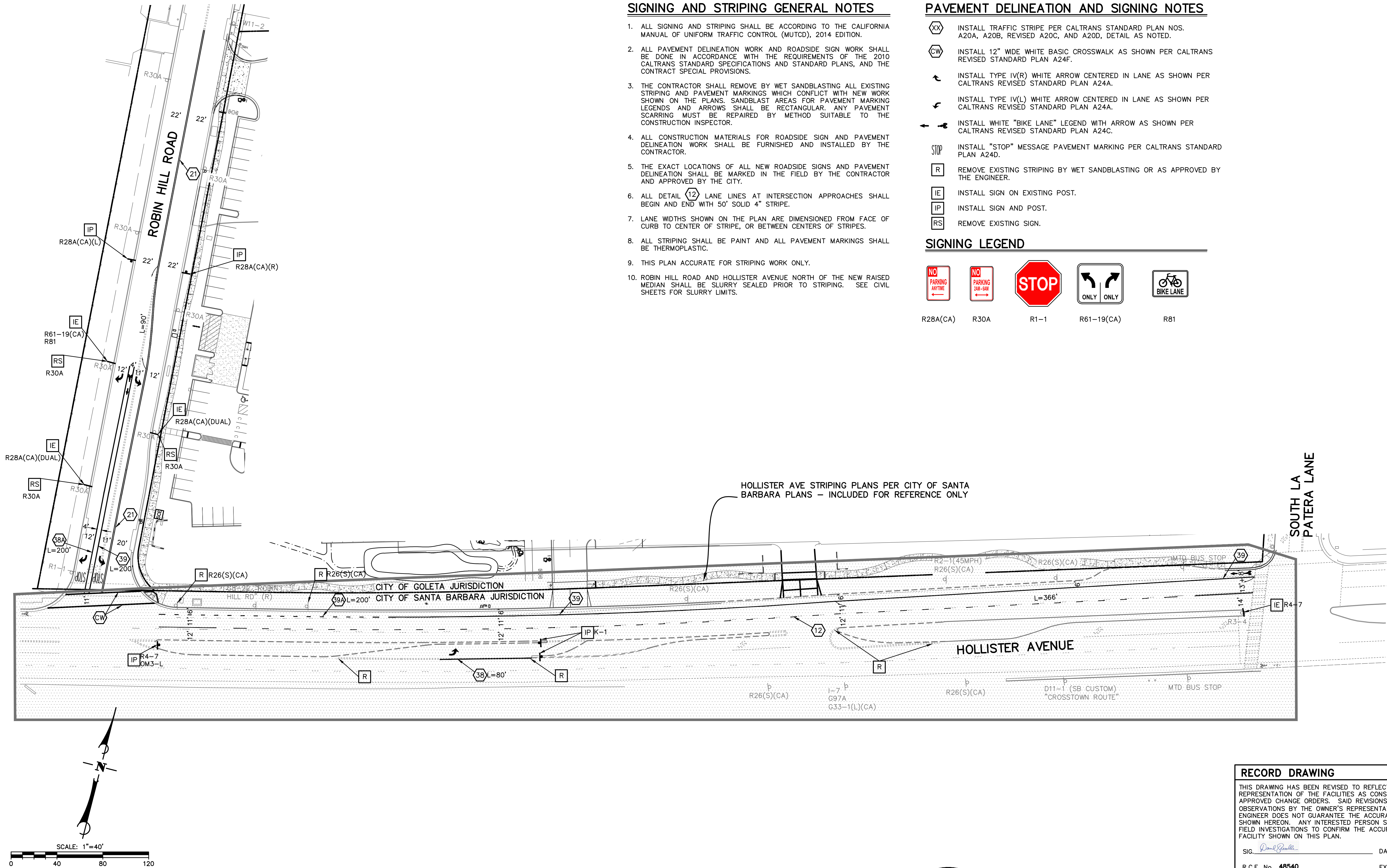

### SIGNING AND STRIPING GENERAL NOTES

- ALL SIGNING AND STRIPING SHALL BE ACCORDING TO THE CALIFORNIA MANUAL OF UNIFORM TRAFFIC CONTROL (MUTCD), 2014 EDITION.
- ALL PAVEMENT DELINEATION WORK AND ROADSIDE SIGN WORK SHALL BE DONE IN ACCORDANCE WITH THE REQUIREMENTS OF THE 2010 CALTRANS STANDARD SPECIFICATIONS AND STANDARD PLANS, AND THE CONTRACT SPECIAL PROVISIONS.
- THE CONTRACTOR SHALL REMOVE BY WET SANDBLASTING ALL EXISTING STRIPING AND PAVEMENT MARKINGS WHICH CONFLICT WITH NEW WORK SHOWN ON THE PLANS. SANDBLAST AREAS FOR PAVEMENT MARKING LEGENDS AND ARROWS SHALL BE RECTANGULAR. ANY PAVEMENT SCARRING MUST BE REPAIRED BY METHOD SUITABLE TO THE CONSTRUCTION INSPECTOR.
- ALL CONSTRUCTION MATERIALS FOR ROADSIDE SIGN AND PAVEMENT DELINEATION WORK SHALL BE FURNISHED AND INSTALLED BY THE CONTRACTOR.
- THE EXACT LOCATIONS OF ALL NEW ROADSIDE SIGNS AND PAVEMENT DELINEATION WORK SHALL BE MARKED IN THE FIELD BY THE CONTRACTOR AND APPROVED BY THE CITY.
- ALL DETAIL 12 LANE LINES AT INTERSECTION APPROACHES SHALL BEGIN AND END WITH 50' SOLID 4" STRIPE.
- LANE WIDTHS SHOWN ON THE PLAN ARE DIMENSIONED FROM FACE OF CURB TO CENTER OF STRIPE, OR BETWEEN CENTERS OF STRIPES.
- ALL STRIPING SHALL BE PAINT AND ALL PAVEMENT MARKINGS SHALL BE THERMOPLASTIC.
- THIS PLAN ACCURATE FOR STRIPING WORK ONLY.
- ROBIN HILL ROAD AND HOLLISTER AVENUE NORTH OF THE NEW RAISED MEDIAN SHALL BE SLURRY SEALED PRIOR TO STRIPING. SEE CIVIL SHEETS FOR SLURRY LIMITS.

### PAVEMENT DELINEATION AND SIGNING NOTES

- INSTALL TRAFFIC STRIPE PER CALTRANS STANDARD PLAN NOS. A20A, A20B, REVISED A20C, AND A20D, DETAIL AS NOTED.
- INSTALL 12" WIDE WHITE BASIC CROSSWALK AS SHOWN PER CALTRANS REVISED STANDARD PLAN A24F.
- INSTALL TYPE IV(R) WHITE ARROW CENTERED IN LANE AS SHOWN PER CALTRANS REVISED STANDARD PLAN A24A.
- INSTALL TYPE IV(L) WHITE ARROW CENTERED IN LANE AS SHOWN PER CALTRANS REVISED STANDARD PLAN A24A.
- INSTALL WHITE "BIKE LANE" LEGEND WITH ARROW AS SHOWN PER CALTRANS REVISED STANDARD PLAN A24C.
- INSTALL "STOP" MESSAGE PAVEMENT MARKING PER CALTRANS STANDARD PLAN A24D.
- REMOVE EXISTING STRIPING BY WET SANDBLASTING OR AS APPROVED BY THE ENGINEER.
- INSTALL SIGN ON EXISTING POST.
- INSTALL SIGN AND POST.
- REMOVE EXISTING SIGN.

### SIGNING LEGEND

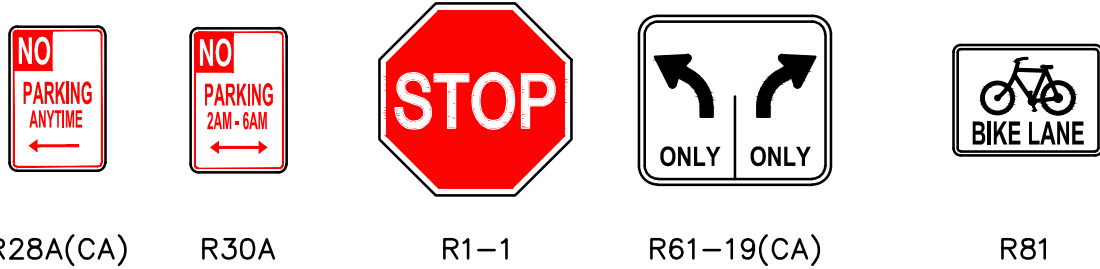

### RECORD DRAWING

THIS DRAWING HAS BEEN REVISED TO REFLECT THE CONTRACTOR'S REPRESENTATION OF THE FACILITIES AS CONSTRUCTED, INCLUDING APPROVED CHANGE ORDERS. SAID REVISIONS MAY ALSO REFLECT THE OBSERVATIONS BY THE OWNER'S REPRESENTATIVES. THE PROJECT ENGINEER DOES NOT GUARANTEE THE ACCURACY OF INFORMATION SHOWN HEREON. ANY INTERESTED PERSON SHOULD MAKE THEIR OWN FIELD INVESTIGATIONS TO CONFIRM THE ACCURATE LOCATIONS OF ANY FACILITY SHOWN ON THIS PLAN.

SIG. David W. Rundle DATE: 11/03/17  
R.C.E. No. 48540 EXPIRES: 06/30/18



111 East Victoria Street, Santa Barbara, CA 93101  
Phone: (805) 963-9532 Fax: (805) 966-9801

DESIGN HGG CHECKED \_\_\_\_\_  
DAVID W. RUNDLE DATE: \_\_\_\_\_  
PROJECT ENGINEER  
R.C.E. 48,540 (EXP. 6-30-18)

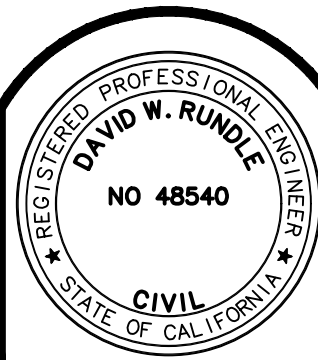

CITY OF GOLETA, CALIFORNIA

REVIEWED BY:

SIGNATURE \_\_\_\_\_ DATE \_\_\_\_\_

ROBIN HILL ROAD AND S. LA PATERA LN  
STREET IMPROVEMENTS  
SIGNING AND STRIPING PLAN  
CITY OF GOLETA, STATE OF CALIFORNIA

P&S PROJECT NO. 17636.02  
SHEET 7 OF 7  
PLAN DATE  
DECEMBER 2, 2015